

Driftsmanual og delekatalog

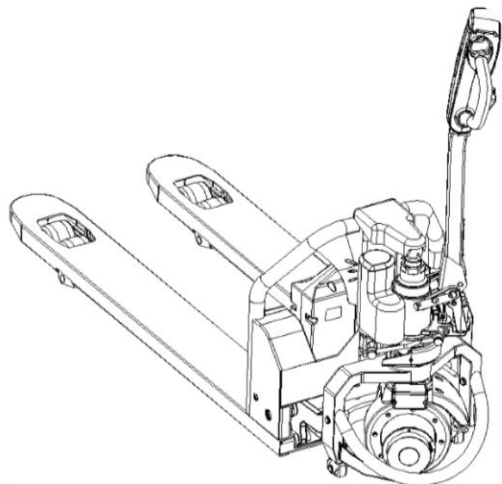

CBD15W-LiX Palletruck med Lithium Batteri

SCANLIFT[®]

Årenga 10 – 1340 Skui

www.scanlift.no | teknisk@scanlift.no



ADVARSEL

Palletrucken skal kun benyttes av person som har vært gitt opplæring i bruk.

Ved bruk av palletrucken skal egnet klær og utstyr benyttes, som f.eks værnesko

Bed bruk av trucken pass på føtter og lemmer som kan komme i klem. Trucken skal ikke benyttes på glatt underlag, som f.eks ved oljesøl eller is/snø

Må ikke benyttes i bratte helninger da lasten kan skli av eller forskyve seg. Sørg for at alle funksjoner er aktive under bruk, også i nedoverbakker

Ved bruk, vær observant og legg merke til omgivelser og underlag

Bruk og fryserom, saltlager eller i korrosive omgivelser er forbudt. Truken er for bruk innendørs på egnet underlag og ikke kontinuerlig utendørs bruk

Overbelastning av vekt ugyldiggjør garanti

Aldri last i høyden slik at sikt reduseres

Ta slake svinger og reduser hastigheten i svinger for å redusere mulighet for at lasten forskyver seg

01/ BESKRIVELSE

-
- 4 Beskrivelse
 - 5 Tekn. Data
 - 6 Layout
 - 7 Tillerhåndtak
-

02/ DRIFT

- 11 Start og stop
 - 12 Løft og senk
 - 13 Brems
 - 14 Auto revers
 - 15 Sikker parkering
-

03/ VEDLIKEHOLD

- 17 Rutinekontroller
 - 18 Elektrisk diagram
 - 19 Hydraulikkolje
 - 20 Løft av pallettrucken
 - 21 Lading og skifte av batteri
 - 25 Feilsøking - Problemløsning
 - 27 Pakklister
-

04/ DELELISTE

-
- 28 Deleliste (Engelsk)
-

01/ BESKRIVELSE

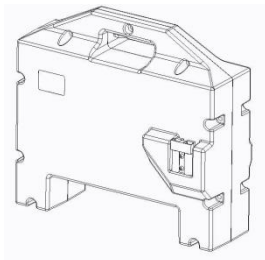
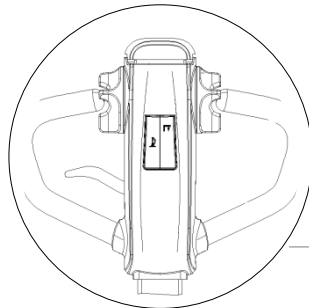
Multi-function Tiller
kontroll

Lithium batteri

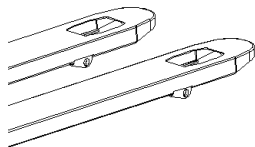
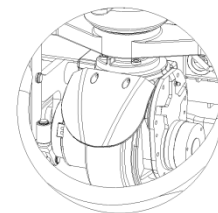
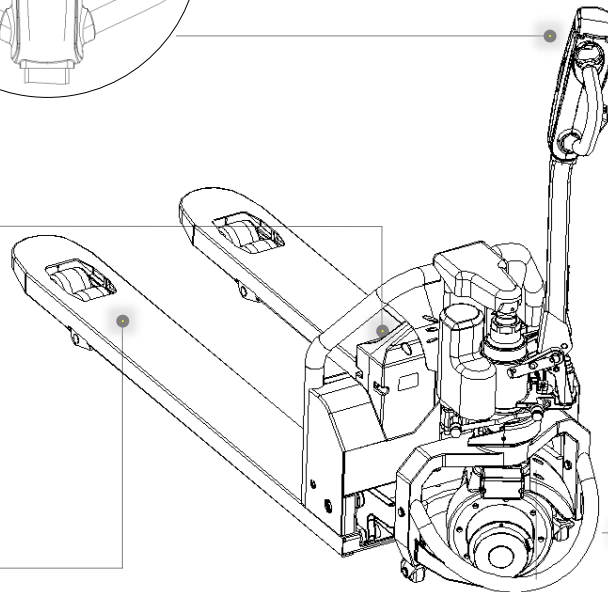
Tapered forktip
Tandem PU rollers
(OPTION)

Driving wheel

Manual Model	Model Navn		CBD15W-LiX
	Lastekapasitet		1500 kg
Chassis Dimensioner	Gafler	Senket høyde	80 mm
		Gaffellengde	1150/1220 mm
		Gaffelbredde	550/685 mm
	Maximum løftehøyde		190 mm
	Vekt		135 kg
Battery	Batteritype		lithium
	Volt		48V/20Ah
Svingradius			1424/1494
Største lengde			1623/1693



- Maks temperatur +40°C eller -10°C.
- For bruk på hard fast grunn
- Må ikke benyttes i eksplosive, etsende eller våte omgivelser
- Max helningsgrad 5%.

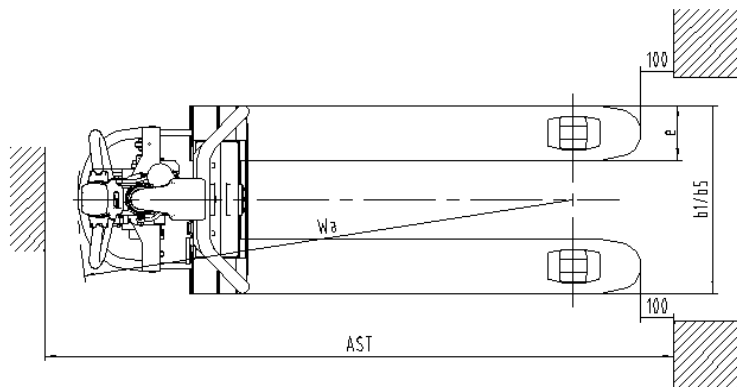
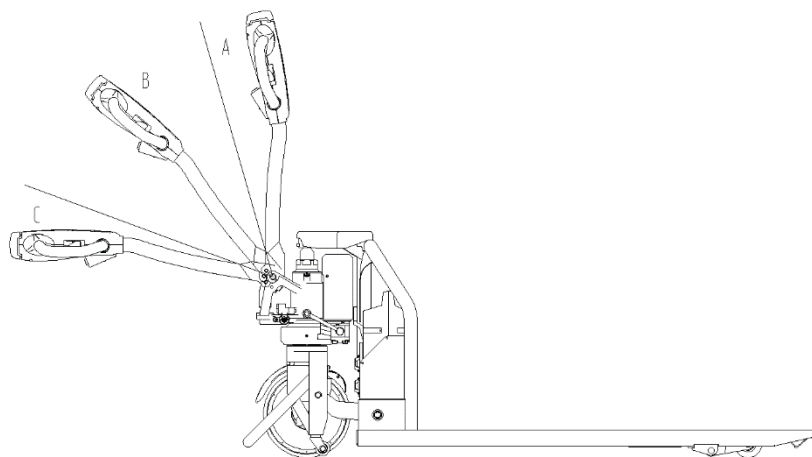
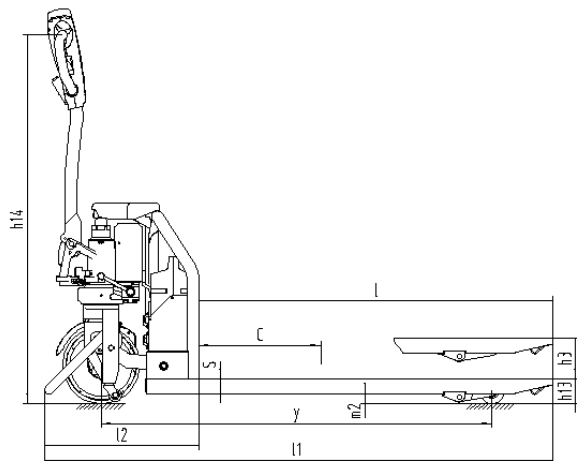



Installasjon av tillerarm (Truken leveres med løs tillerarm)

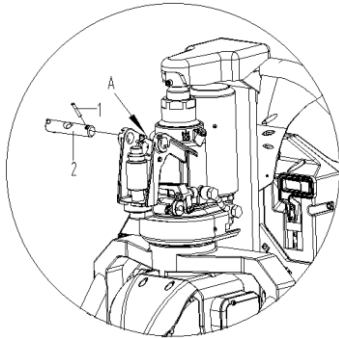

Fig. 1

1. Fjern pin 1 from pin 2, trek ut pin 2.

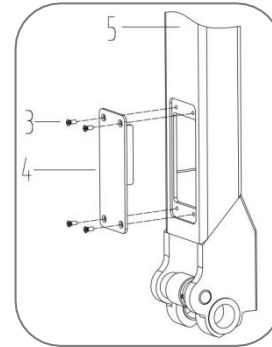

Fig. 2

2. Løsne skruer 3, Fjern plate 4 fra tiller assy 5.

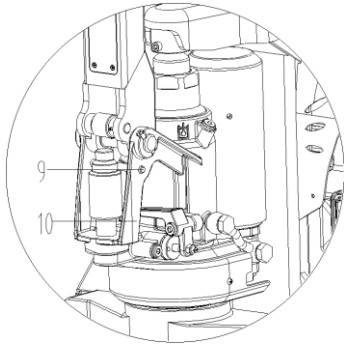

Fig. 3

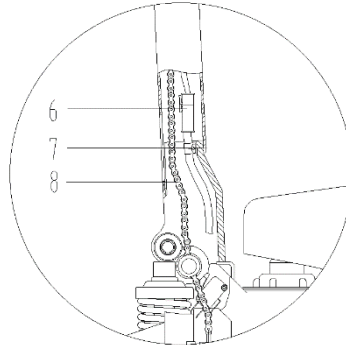

Fig. 4

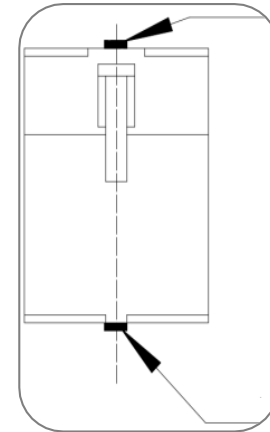

Fig. 5

3. Stikk in tillerarm 5 (Fig. 2) i A (Fig. 1), sammenkoble tiller assy 5 til pumpe 10 med pin 2. Trekk kjedet 8 igjennom hullet 2. Vipp arm i horizontal posisjon, trek ut pin 9.

Koble samme wire 5 til chassis 6, trekk koblingen godt til (ref Fig.5). Koble til 5 med 7 ihht Fig. 4.

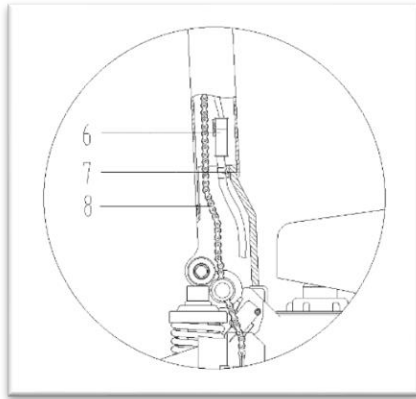

Fig. 4

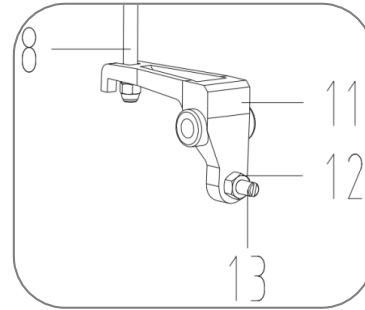
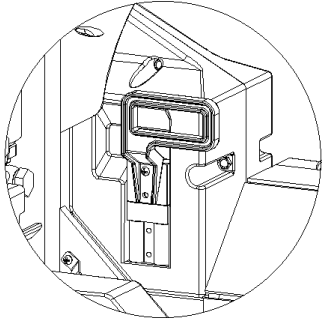

Fig. 6

4. Se fig . 4 & 6, Monter gjengestag med skrue 8 I pendel 11.

02/ DRIFT



Monter batterikontakt

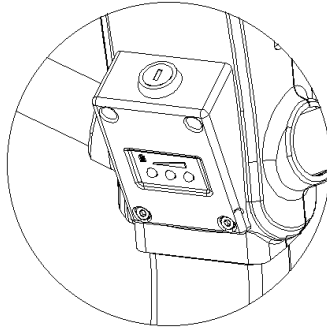

Skru på nøkkelbryter.

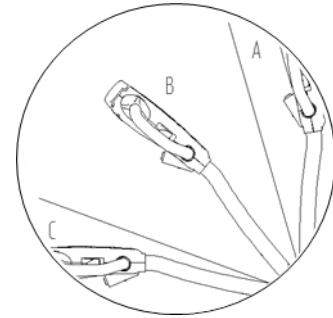

Sett tillerarm I posisjon B.
A og C er bremseposisjoner

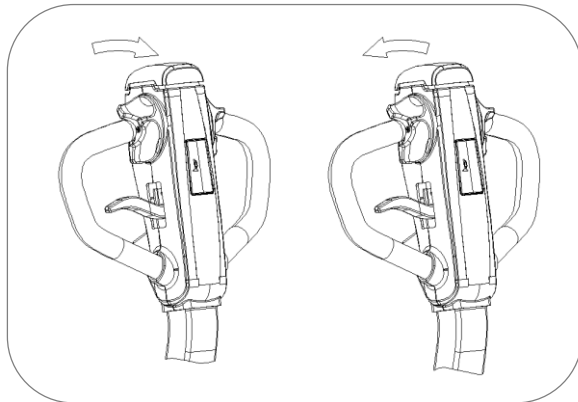

Roter akselrator for å starte trucken (Sakte forsiktig).
Vri tilbake for å redusere hastighet.

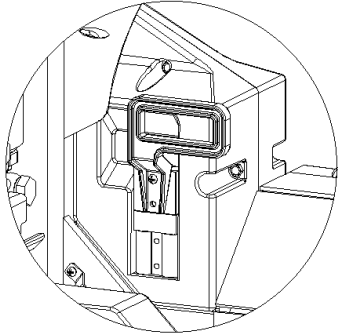

Monter batterikontakt

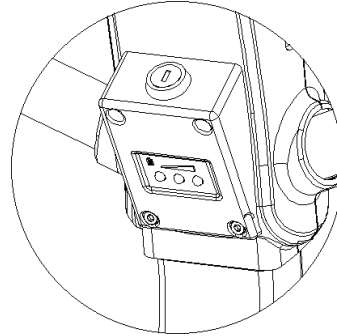

Aktiver nøkkelbryter.

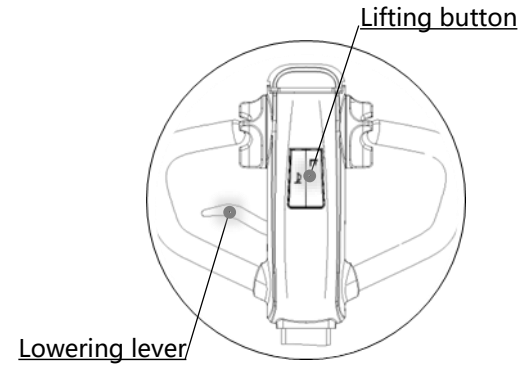

Press " Lift " for å løfte . Trekk i senkespaken for å senke gaffler og last

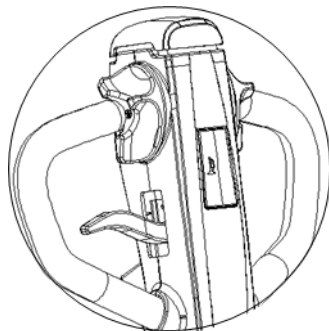

Reduser hastighet ved å skru tilbake akselratorhjul, Trucken stopper ved regenerative bremseffekt

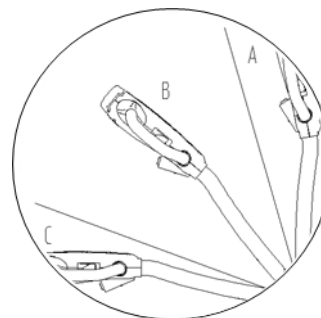

Vipp tillerarm I posisjon A eller C for rask oppbremsing

AUTO REVERS – Lovpålagt sikkerhetsmekanisme for å unngå klemfare av operatør. Ved aktivering under drift vil palletrucken reversere driftsretning og gå fremover dersom bryter aktiveres

Auto revers bryter

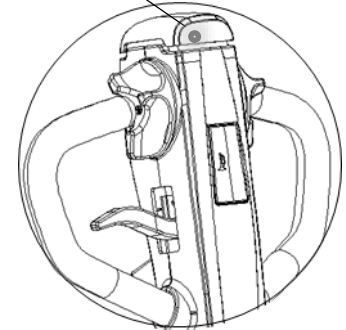

Senke hastighetfor å stanse

Senke gafler til laveste poosisjon.

Nøkkelplyter

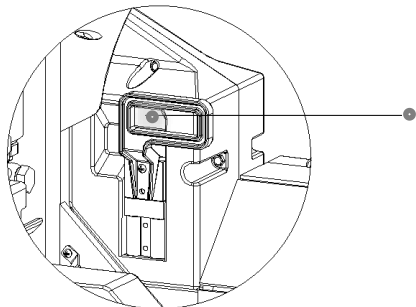
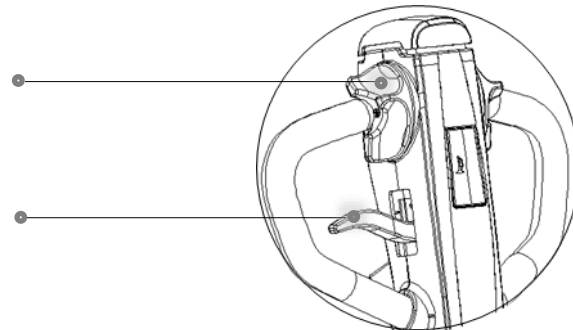

Koble fra batteri ved lengre tids stillstand uten bruk.

03/ VEDLIKEHOLD

Daglig vedlikehold – Hold trucken ren og påse at elektriske kabler er uskadet.

Ukentlig vedlikehold : Kontroller komponenter som, alle bolted komponenter, oljelekkasjer , unormal slittasje , og om eventuelt høye driftstemperaturer hor kortslutninger , etc.

Periodisk vedlikehold
(Konf tabell)

Elektrisk anlegg Hver 3 mnd	Hydraulisk anlegg Årlig	Mekaniske komponenter Hver 6 mnd
<ul style="list-style-type: none"> <input type="checkbox"/> Kontroller elektriske koblinger <input type="checkbox"/> Kontroller bryterfunksjoner <input type="checkbox"/> Kontroller el-isolering på elektriske kabler og kontakter <input type="checkbox"/> Kontroller motstand mellom chassis og el. Komponenter $\geq 0.5M\Omega$s 	<ul style="list-style-type: none"> <input type="checkbox"/> Kontroller hydraulikkomponenter for slittasje og lekkasjer <input type="checkbox"/> Kontroller oljenivå <input type="checkbox"/> Kontroller hydraulikksylindre/stempler <input type="checkbox"/> Sjekk overbelastningsventil <input type="checkbox"/> Skift hydraulikkolje årlig 	<ul style="list-style-type: none"> <input type="checkbox"/> Kontroller gearbox for lyder og lekkasjer <input type="checkbox"/> Kontroller lager og svingekanismer <input type="checkbox"/> Smår alle roterende deler <input type="checkbox"/> Ettetrekk eventuelle løse koblinger <input type="checkbox"/> Kontroller gafler

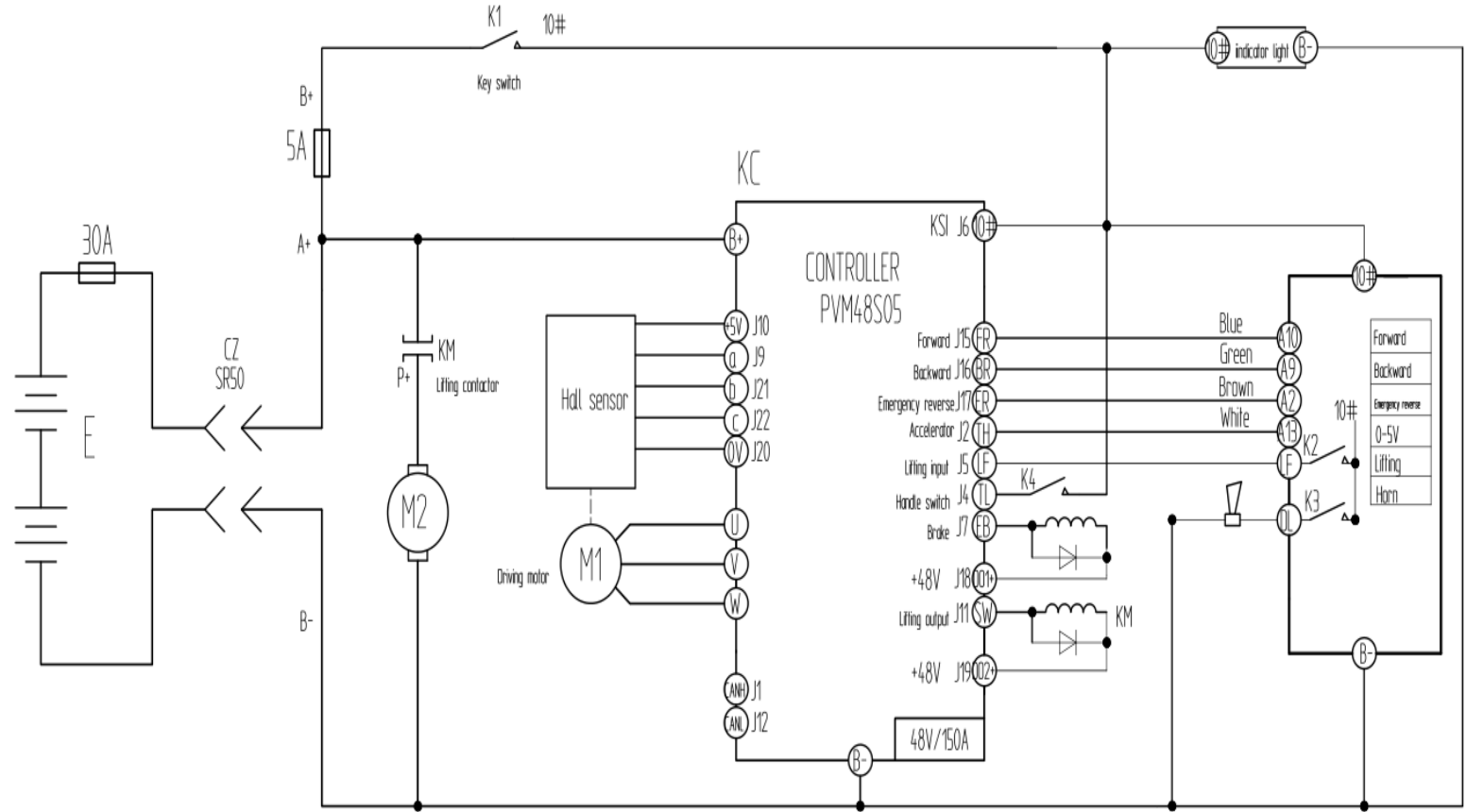

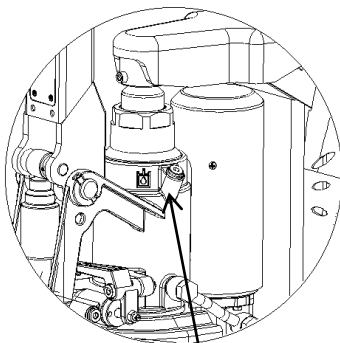

Oljepåfylling

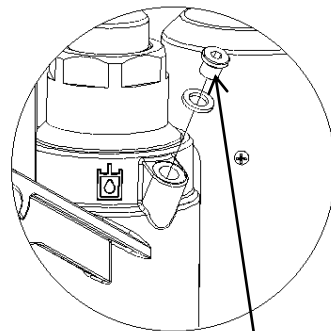
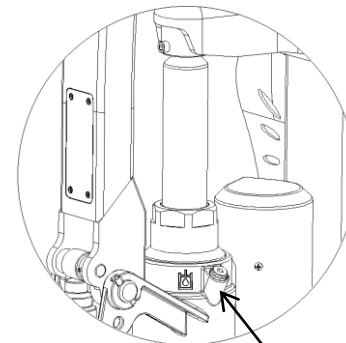
Fjerne påfyllingsskrue og fyll på 250ml
hydraulikkolje ISO 32Trekk I senkemekanismen 2-3
ganger, og løft til høyeste nivå før skruen
trekkes til. Skift eventuell skadet skive

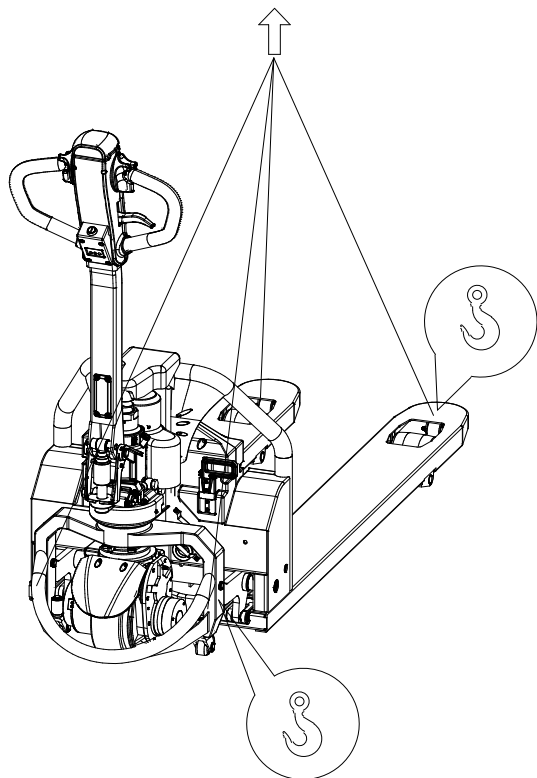

Kroker festes i angitte punkter før løft. Aldri dra trucken på abrasivt underlag da dette vil slite driftshul ujevnt og ugyldiggjøre garanti

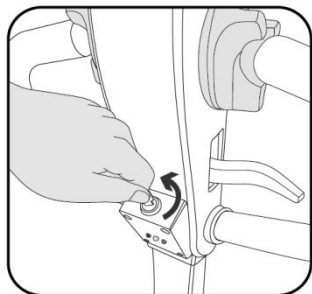

1

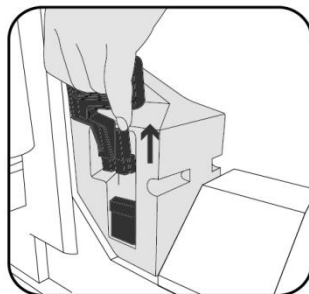

2

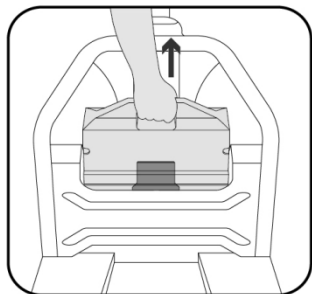

3

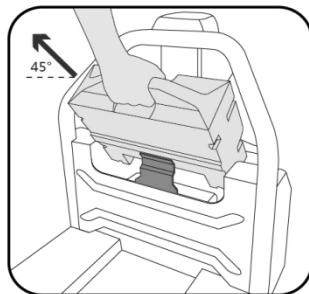

4

1. Skru av nøkkelbryter
2. Koble fra batterikabel.
3. Trekk batteri ut av kassen
4. Vend 45-grader for å frigi fra rammen.

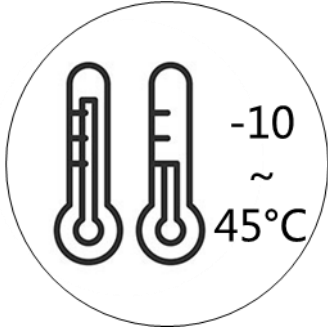

Batteriets optimale arbeidstemperatur er -10 ~ 45°C.



Lade og utlade batteriet hver 3 mnd ved lengre tids lagring



Hold batteri unna vann og varme



- Fullade batteriet før bruk.
- Ikke kortslutte batteriet.
- Aldri reparere eller endre batteriet
- Oppbevare batteriet i optimale forhold, aldri ekstreme temperaturer, dyp utlading eller hyppig overlading, eller utlading
- Ved skifte ab batteri , bruk håndtaket, ikke dra I kabel.
- Batteriet kan bli varmt ved lading, kjøøl dette ned I ventilert rom.
- Påse at batteriet er uskadet. Batterisyre er etsende , skadelig og miljøforurensende.
- Hold batteriet unna barn og dyr. Kontakt umiddelbart lege ved syreskader

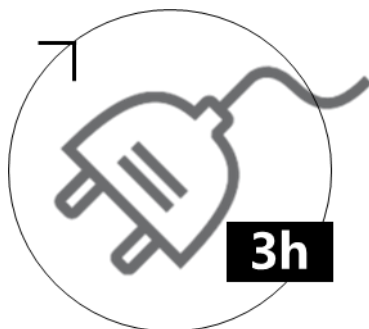

Lithium batteriet fullades i løpet av 3 timer.

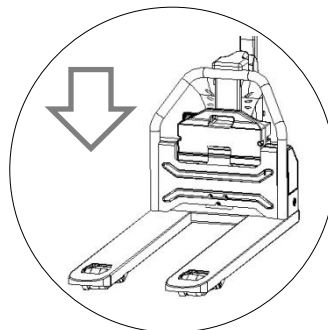

Batteriet skal tilkobles med korrekte poler + og minus

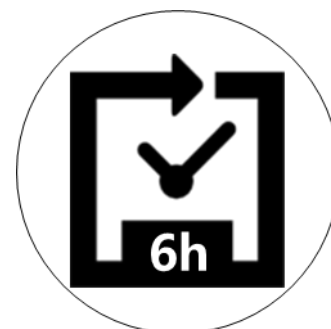

Driftstid med fulladet batteri er 6 timer

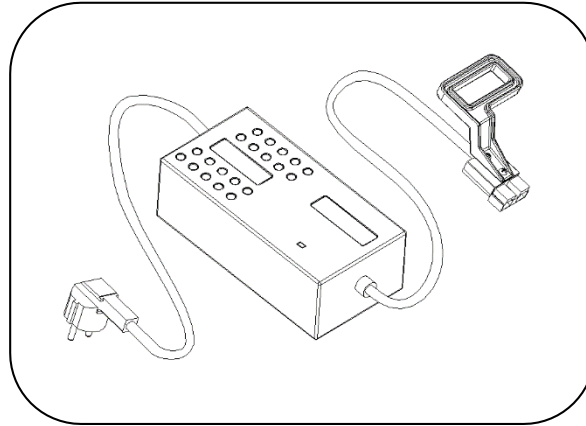

Li-ion LADER



- Kun medlevert lader skal benyttes; Arbeids-Volt er 48V, Max lade belastning er 54.6V, ved 6-7 Amp.
- Aldri feilkoble lader, påse at + og – tilkobles korrekt.
- Stans lading umiddelbart dersom batteriet blir uforholdsmessig varmt. Lade på nytt etter at batteriet er naturlig avkjølt
- Benytt håndtak i ladekabel for å frakoble , ikke trekk i wirekabel.

Lampe indikator . Batteri - Lader

Grønt lys – lyser konstant: 70%-100% power

Gult lys - Lyser konstant: 40%-70% power

Rødt lys - Lyser konstant: 10%-40% power

Blinkende rød lampe: Nesten tomt batteri – Lading påkrevet

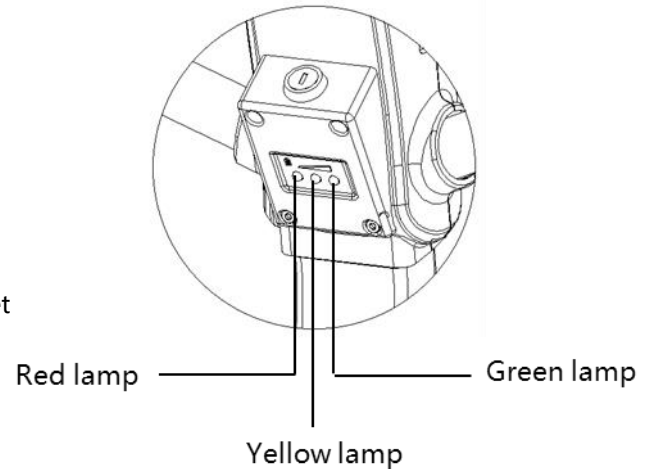

- Når Rød lampe lyser - Skift batteri, eller sett på lading
- Ved blinkende rød lampe ber trucken om lading umiddelbart.
- Ved fortsatt bruk, vil batteribeskyttelses bryter i batteriet aktiveres , og strømmen vil kuttes.

Ved driftsproblemer, konf. Nedenstående for råd

No.	Faults	Analysis of cause	Trouble shooting
1	Hydraulisk olje lekkasje	<ol style="list-style-type: none"> 1. Slitte sylinderpakninger 2. Slitte flater på komponenter 3. Løse komponenter 	<ol style="list-style-type: none"> 1. Skift sylinderpakninger 2. Identifiser og skift komponenter 3. Ettetrekk løse skruer/komponenter
2	Vil ikke løfte	<ol style="list-style-type: none"> 1. For tykk hydraulikkolje 2. Uren hydraulikkolje 3. Skadet hydraulikkpumpe/motor 	<ol style="list-style-type: none"> 1. Skift til lavere viskositet 2. Skift hydraulikkolje 3. Skift kraftenheten
3	Vil ikke senke	Juster senke spaken og juster kjedetrekket	Juster posisjon til senkeventilen
4	Motor virker ikke	<ol style="list-style-type: none"> 1. Nøkklebryter er ikke påskrudd 2. Batteriet er ikke ladet 3. Bremsen er ikke deaktivert 4. Sikringsbrudd 	<ol style="list-style-type: none"> 1. Sett i nøkkel og aktivere 2. Lade batteriet 3. Sjekk at ikke bryter er aktivert eller henger etter skade 4. Skift sikring
5	Vil ikke lade	Skadet lader	Skift lader



Påse at all deler og komponenter, flytende væsker som batterier og olje deponeres i henhold til lovpålagte miljøvernforskrifter.

Pakklister

Consignee:
Contract No.:

Ex-work No.:
Ex-work Date:

No.	Name	Qty	Net weight (kg)	Dimension (L×W×H)	Remarks
1	CBD15W-LiX Palletruck	1			Komplett
2	Accessory box	1			Technical documents, accessories and spare parts.

Note: 1. Medfølgende deler

- | | |
|-----------------|----------|
| ① Driftsmanual | 1 volume |
| ② Delekatalog | 1 volume |
| ③ CE Sertifikat | 1 copy |
| ④ Pakklister | 1 copy |

2. Utstyr og slitedeler

No.	Name	Application	Type & specification	Qty	Remarks
1	Nøkklebryter	Unlock the electric lock		2	
2	Lader	Lithium battery charging		1	
3	Sikring 5A	Electrical part		1	
4	Støvpakning	Oil cylinder	DHS40	1	
5	Pakning	Oil cylinder	UHS40	1	
6	O-ring	Oil cylinder	40X3.55	1	
7	O-ring	Oil cylinder	67X3.55	1	
8	O-ring	Oil cylinder	46.2X2.65	1	
9	Kabelsett	Wiring harness connection	3X150	1	
10	Fixed button	Fix the wiring harness	ACC-2-B	1	
11	Screw	Fix the wiring harness	M4X6	1	

04/ DELELISTE

General Assembly.....	30
Backrest Assembly.....	32
Handle Tiller.....	33
Electric System.....	35
Hydraulic System.....	37
Oil cylinder assembly.....	38
Motor Pump.....	40
Steering Gear Assembly.....	41
Handle Assembly.....	43
Horizontal driving wheel assembly.....	45
Double Wheel System.....	47



Electric Pallet Truck (CBD15W-LiX) General Assembly

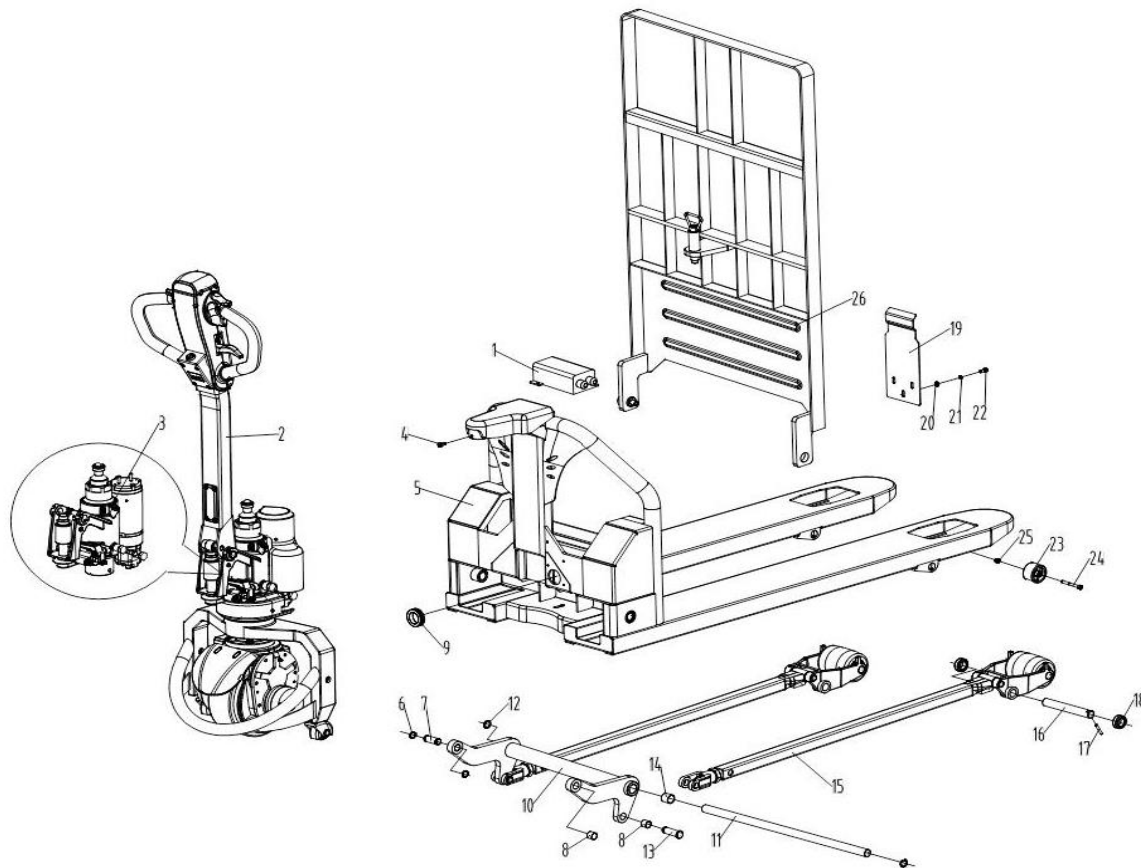

General Assembly

Item No	Drawing NO.	Part NO.	Name		Q'ty	Remarks
1	CBD15W-LiX.01A-00		Electrical system		1	
2	053.02.0005.04	30402000104	Steering gear assembly		1	
3	CBD12W-Li.02-00		Hydraulic system		1	
4	GB/T70.1	41100000037	Screw M6X12		1	
5	CBD12W-Li.06A-00	30701000784	Truck frame assembly	550X1150	1	with reinforcing rib
		30701000785	Truck frame assembly	550X1220		with reinforcing rib
		30701000786	Truck frame assembly	550X1150with backrest		with reinforcing rib
		30701000787	Truck frame assembly	550X1220with backrest		with reinforcing rib
	CBD12W-Li.06B-00	30701000788	Truck frame assembly	685X1150		with reinforcing rib
		30701000789	Truck frame assembly	685X1220		with reinforcing rib
		30701000790	Truck frame assembly	685X1150with backrest		with reinforcing rib
		30701000791	Truck frame assembly	685X1220with backrest		with reinforcing rib
6	GB/T894.1	41305000008	Circlip for shaft 16		6	
7	001.02.0160.09	21701000024	Pin		2	
8	Q/NRY031	43100000018	Bearing SF-1-16.16		4	
9	260.06.0400.01	21001000001	Rubber coil		1	
10	141.02.0550.03	31601000033	Rocker arm assembly	550	1	
	141.02.0680.04	31601000034	Rocker arm assembly	685		
11	001.03.0200.50	21704000030	Shaft	550	1	
		21704000031	Shaft	685		
12	GB/T893.1	41304000005	Circlip for hole 20		2	
13	001.05.0160.16	21703000075	Shaft		2	
14	Q/NRY031	43100000033	Bearing SF-1-20.20		2	
15	CBD12W-Li.16-00	31605000009	Connecting rod and wheel carriage assembly	1150single wheel	2	
		31605000010	Connecting rod and wheel carriage assembly	1220single wheel		
		31605000011	Connecting rod and wheel carriage assembly	1150double wheel		
		31605000012	Connecting rod and wheel carriage assembly	1220doble wheel		
16	001.01.0200.39	21702000069	Pin		2	
17	GB/T879	41402000022	Pin 5X32		2	
18	020.03.0034.01	21312000028	Reverse-assisted wheel		4	
19	CBD12W-Li-01	22003000194	Battery platen		1	
20	GB/T97.1	41301000004	Washer 6		3	
21	GB/T93	41300000004	Washer 6		4	
22	GB/T70.1	41100000041	Screw M6X16		2	
23	020.04.0050.01	21312000093	Small wheel		2	
24	GB/T5782	41001000003	Screw M6X55		2	
25	GB/T889.1	41208000005	Locknut M6		2	
26	CBD12W-Li.22-00	30613000001	Backrest assembly	550	1	
		30613000002	Backrest assembly	685		

Backrest Assembly

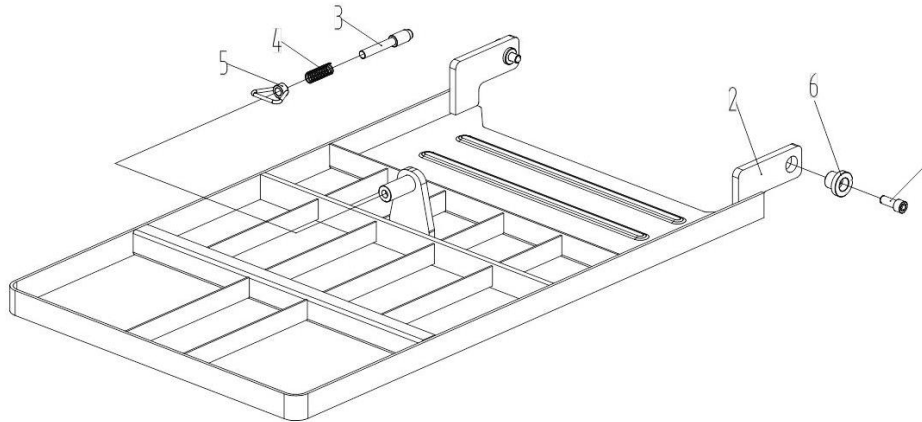

Item No	Drawing NO.	Part NO.	Name		Q'ty	Remarks
1	GB/T70.1	4110000128	Screw M12X30		2	
2	CBD12W-Li.22.01-00	30613000003	Backrest welding	550	1	
		30613000004	Backrest welding	685		
3	001.05.0180.21	21703000101	Pin		1	
4	040.01.0115.02	21605000020	Spring		1	
5	BFR.25-00	30915000004	Ring-pull		1	
6	BFR-01	21810000207	Platen		2	

Handle tiller

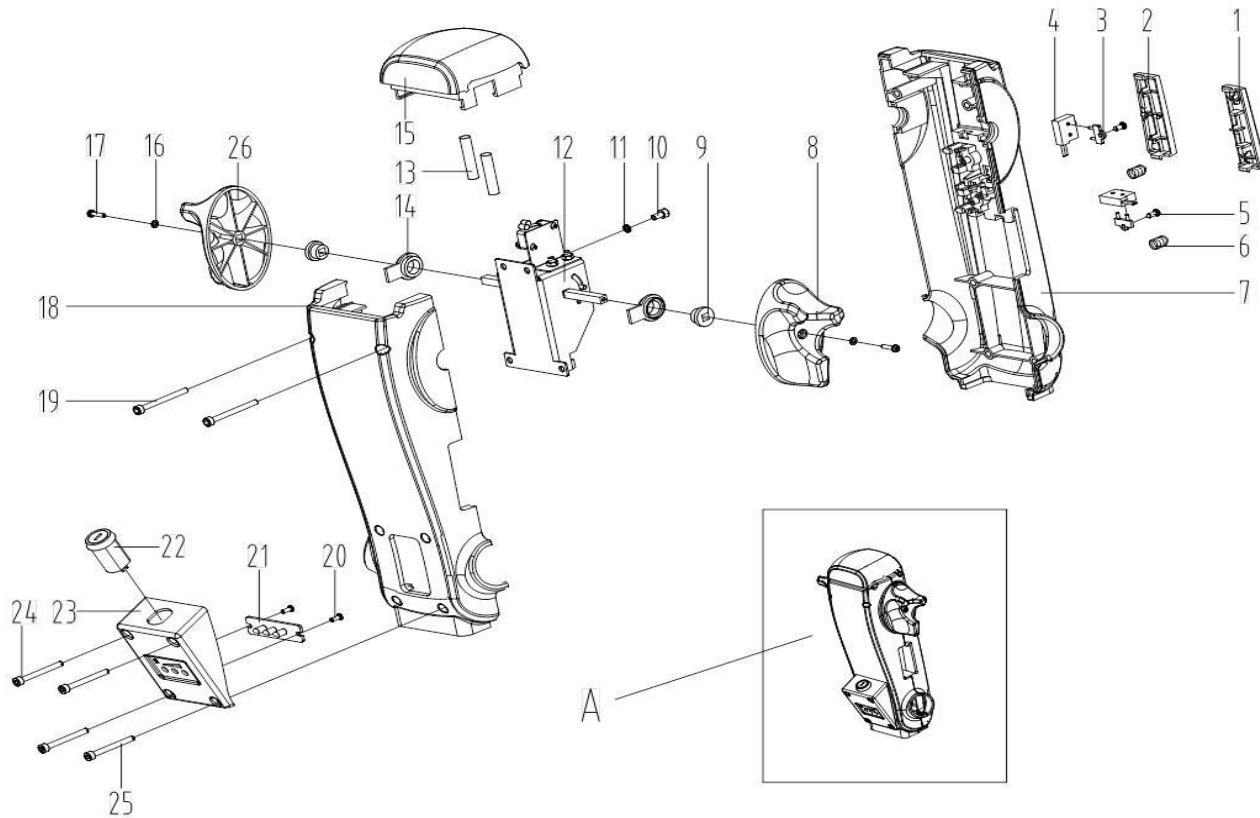

Handle tiller

Item No	Drawing NO.	Part NO.	Name		Q'ty	Remarks
1	263.01.0000.07	20407000002	Horn button		1	
2	263.01.0000.17	20404000001	Lifting button		1	
3	263.99.0000.24	20418000021	Microswitch insert		2	
4	740.99.0007.02	35612000017	Microswitch		2	
5	GB/T845	41113000003	Screw ST2.9X6.5		2	
6	040.01.0108.05	21605000053	Spring		2	
7	263.05.0000.10	30916000003	Upper cover		1	
8	263.01.0000.05	20409000001	Rotary knob right		1	
9	263.99.0000.28	21808000031	Bush		2	
10	GB/T70.1	41100000005	Screw M4X8		2	
11	GB/T93	41300000002	Washer 4		2	
12	741.01.4801.02	35501000009	Accelerator ACC-12		1	
13	040.01.0108.04	21605000052	Brake spring		2	
14	263.99.0000.38	21816000005	Support cover		2	
15	263.01.0000.04	20403000002	Brake switch		1	
16	GB/T862.2	41313000001	Washer 3		2	
17	GB/T818	41108000004	Screw M3X12		2	
18	263.05.0000.44	30917000004	Lower cover		1	
19	GB/T70.1	41100000013	Screw M4X40 (black)		2	
20	GB/T845	41113000004	Screw ST2.9X9.5		2	
21	733.01.0248.01	35503000005	Instrument		1	
22	740.99.0008.01	35602000006	Key accessory		1	
23	263.05.0000.45	20429000003	Lock cover		1	
24	GB/T70.1	41100000020	Screw M4X65 (black)		2	
25	GB/T70.1	41100000017	Screw M4X55 (black)		2	
26	263.01.0000.22	20409000004	Rotary knob left		1	

Electrical System

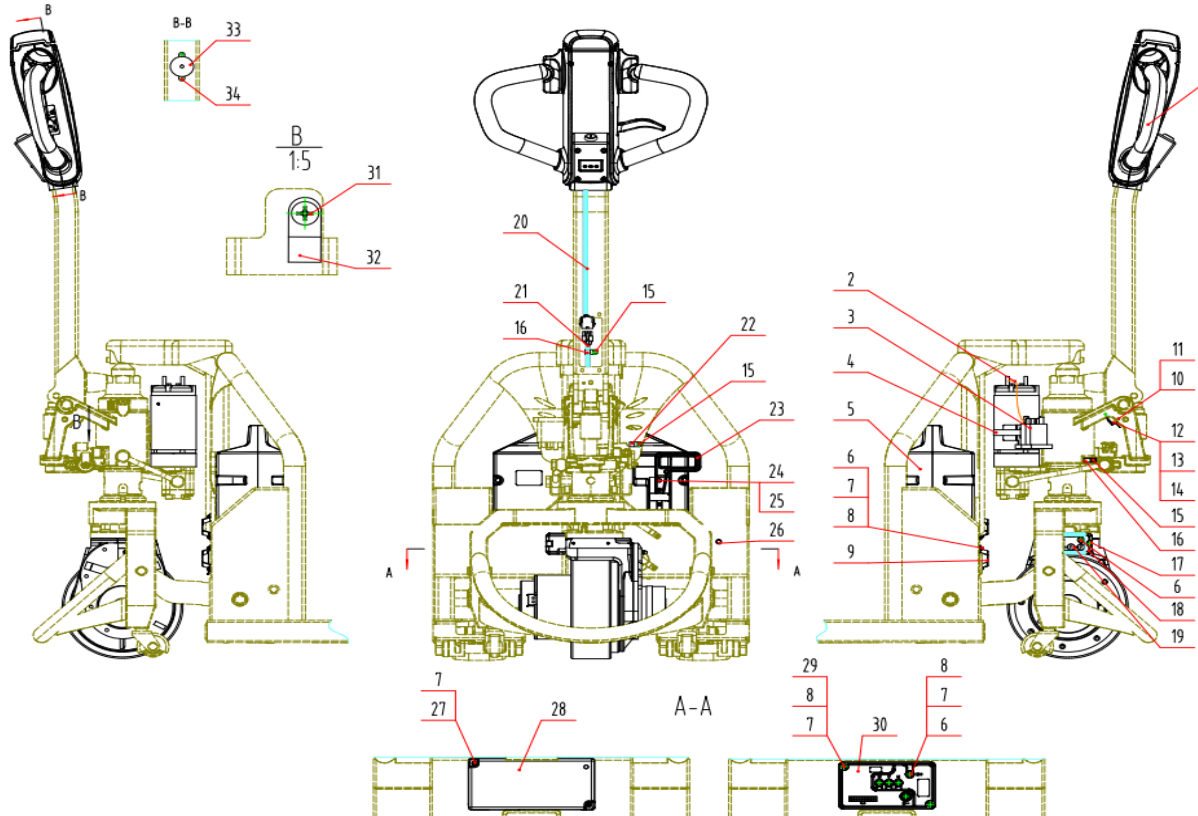

Electrical System

Item No	Drawing NO.	Part NO.	Name	Q'ty	Remarks
1	740.01.0005.01	30910000005	Tiller RYTL3-1	1	see1.01
2	CBD12W-Li.01.02-03	35404000058	P+ connecting wire	1	
3	761.02.4200.01	35902000013	Lifting contactor	1	
4	226.02.0800.01	21009000044	Hoop (diameter 70-89, width 12)	1	
5	CBD12W-Li.01.04-00	35304000002	Lithium-battery pack assembly	1	
6	GB/T818	41108000015	Screw M4X12	7	
7	GB/T93	41300000002	Washer 4	13	
8	GB/T97.1	41301000002	Washer 4	11	
9	CBD12W-Li.01-01	220030000547	Line buckle	2	
10	GB/T818	41108000007	Screw M3X25	2	
11	GB/T93	41300000001	Washer 3	2	
12	CBD12W-Li.01-03	21912000035	Plastic plate	1	
13	730.12.0201.02	35612000010	Microswitch TMV164-C	1	
14	CBD12W-Li.01-02	21910000082	Microswitch platen	1	
15	GB/T818	41108000011	Screw M4X8	3	
16	835.05.0000.02	21006000009	Fixed buckle ACC-2-B	2	
17	GB/T818	41108000023	Screw M4X35	2	
18	263.05.0000.43	20504000008	Line box	1	
19	835.06.0003.03	20431000006	Wiring board	1	
20	CBD12W-Li.01.02-02	35401000024	Handle wiring harness	1	
21	CBD15W-LiX.01A.02-01	35401000203	Truck body wiring harness	1	
22	835.05.0000.04	21006000011	Fixed buckle ACC-3-B	1	
23	826.03.0000.06	21404000009	Puller	1	
24	GB/T818	41108000020	Screw M4X25	2	
25	GB/T889.1	41208000002	Locknut M4	2	
26	835.08.0005.01	20422000001	diode base(5mm)	1	
27	GB/T70.1	41100000013	Screw M4X40	2	
28	263.04.0000.10	20521000004	Controller cover	1	
29	GB/T818	41108000017	Brushless controller	2	
30	711.05.4408.04	35106000010	Terminal	1	
31	GB/T818	41108000030	Locknut M5	1	
32	835.05.0000.05	21006000012	Screw M5X12	1	
33	CBD12W-Li.01-04	35703000007	Buzzer accessory	1	
34	GB/T818	41108000004	Screw M3X12	2	

Hydraulic System

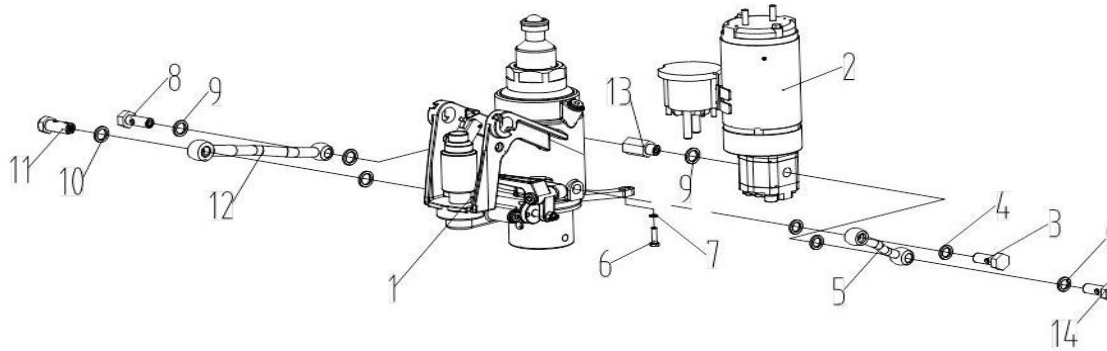

Item No	Drawing NO.	Part NO.	Name	Q'ty	Remarks
1	490.03.1400.01	31001000128	Oil cylinder assembly	1	
2	CBD12W-Li.02.01B-00	30218000014	Motor pump	1	
3	428.00.0012.01	20313000165	Joint	1	
4	JB/T982	44007000026	Washer 12	2	
5	401.05.1282.01	31015000138	Oil inlet rigid pipe	1	
6	GB/T5783	41002000007	Screw M6X20	2	
7	GB/T93	41300000004	Washer 6	2	
8	428.00.0082.01	20313000178	Joint	1	
9	JB/T982	44007000022	Washer G1/4	5	
10	JB/T982	44007000008	Washer 14	2	
11	428.00.0014.02	20313000167	Joint	1	
12	401.05.1482.01	31015000139	Oil outlet rigid pipe	1	
13	420.09.8282.01	20313000087	Joint	1	
14	428.00.0082.02	20313000251	Joint	1	

Oil Cylinder Assembly

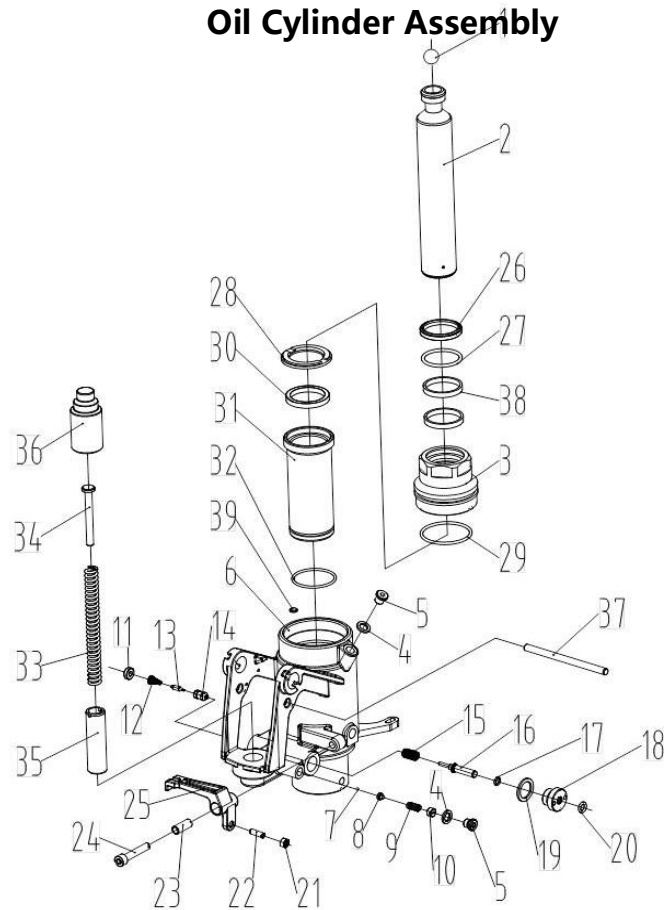

Oil Cylinder Assembly

Item No	Drawing NO.	Part NO.	Name	Q'ty	Remarks
1	GB/T308	40002000017	Steel ball 3/4	1	
2	505.01.0400.01	20304000231	Piston rod	1	
3	506.09.0402.01	20307000024	Hood	1	
4	JB/T982	44007000005	Washer 10	2	
5	223.02.0010.02	20104000007	Plug	2	
6	510.01.0400.01	21205000040	Bottom seat	1	
7	GB/T308	40002000006	Steel ball 5	1	
8	506.15.0080.01	21210000006	Seat	1	
9	040.01.0206.06	21605000087	Spring	1	
10	506.16.0100.02	20101000032	Screw M10X1	1	
11	506.16.0140.04	20101000038	Screw	1	
12	040.01.0111.01	21605000046	Spring	1	
13	506.11.0050.01	20213000003	Valve core	1	
14	506.12.0050.01	20212000006	Valve body	1	
15	040.01.0108.01	21605000054	Spring	1	
16	506.04.0080.01	20218000001	Striker pin	1	
17	GB/T3452.1	44006000006	O-ring 6.9X1.8	1	
18	506.14.0080.02	20104000018	Striker pin seat	1	
19	JB/T982	44007000016	Washer 20	2	
20	GB/T3452.1	44006000010	O-ring 8X2.65	1	
21	GB/T6170	41200000005	Nut M6	1	
22	GB/T73	41104000004	Screw M6X25	1	
23	001.06.0100.10	21706000002	Shaft	1	
24	GB/T70.1	41100000073	Screw M8X45	1	
25	506.02.0100.01	21222000017	Lever plate	1	
26	Q/NRY032	44112000017	Dust ring DHS4048-5/6.5	1	
27	GB/T3452.1	44006000059	O-seal ring 40X3.55	1	
28	506.99.0000.93	20526000010	Platen	1	
29	GB/T3452.1	44006000093	O-seal ring 67X3.55	1	
30	Q/NRY032	44100000020	Seal ring UHS40-50-6	1	
31	506.99.0000.94	20308000260	Inner cylinder	1	
32	GB/T3452.1	44006000068	O-seal ring 46.2X2.65	1	
33	040.01.0312.02	21605000088	Spring	1	
34	506.99.0000.97	21703000299	Spring core	1	
35	506.99.0000.95	21810000151	Spring sleeve	1	
36	506.99.0000.96	20310000002	Outer sleeve	1	
37	001.03.0080.60	21704000011	Locking rod	1	
38	Q/NRY032	44115000003	Guide tape BST5806-6-2.5	Φ40 2	
39	225.02.0100.01	21925000002	Magnetic steel	1	

Motor Pump

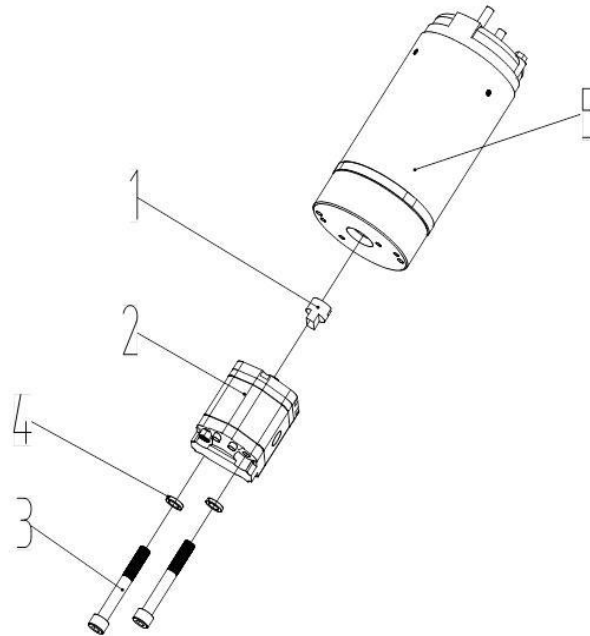

Item No	Drawing NO.	Part NO.	Name		Q'ty	Remarks
1	CBD12W-Li.02.01B-01	21812000014	Connector		1	
2	480.01.0008.01	30218000011	Pump		1	
3	GB/T70.1	41100000034	Screw M5X70		2	
4	GB/T93	41300000003	Washer 5		2	
5	701.48.0800.03	35205000031	DC motor		1	

Steering Gear Assembly

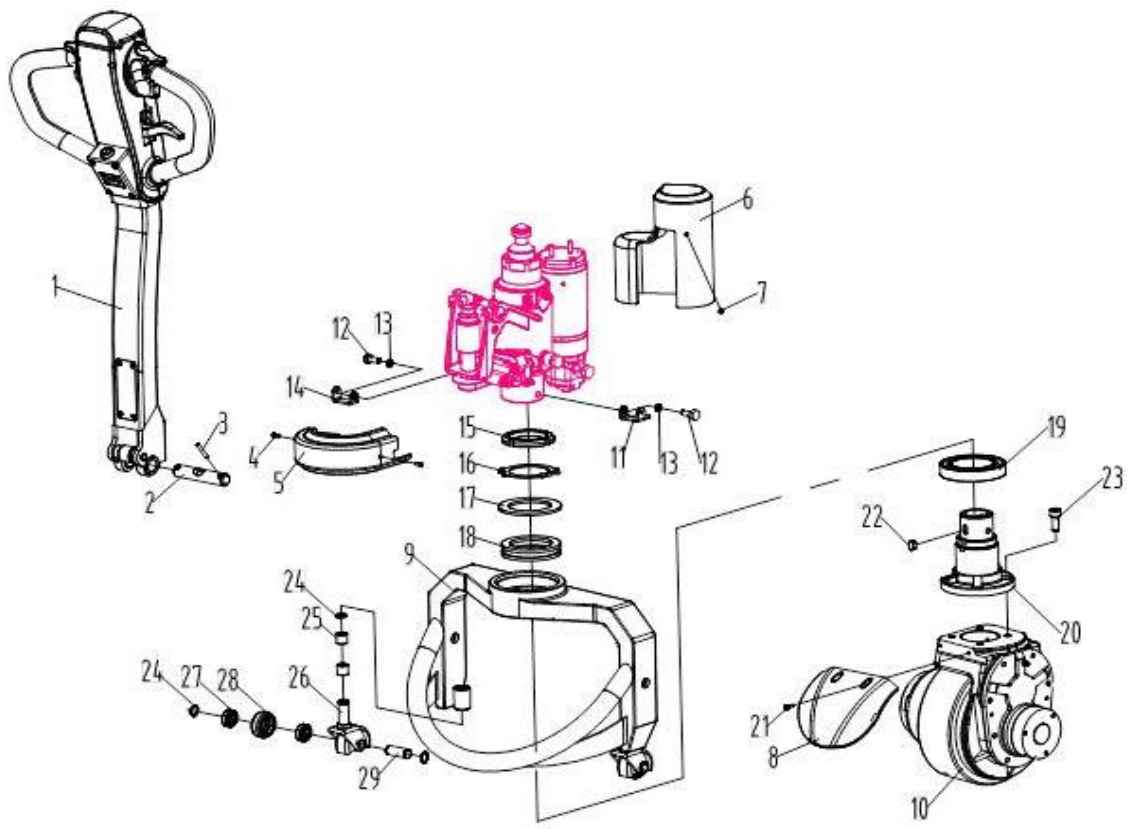

Steering Gear Assembly

Item No	Drawing NO.	Part NO.	Name	Q'ty	Remarks
1	056.02.0107.05	30905000004	Handle assembly	1	
2	001.01.0200.18	21702000052	Pin	1	
3	GB/T879	41402000022	Pin 5X32	2	
4	GB/T818	41108000007	Screw M4X10	2	
5	263.04.0000.07	20521000002	Decorative cover	1	
6	263.04.0000.08	20521000003	Motor housing	1	
7	GB/T818	41108000028	Screw M5X10	2	
8	263.99.0000.43	20511000002	Mud guard	1	
9	066.03.0200.07	31110000020	Support seat assembly	1	
10	082.01.0210.01	30304000005	Horizontal Driving wheel assembly	1	
11	065.05.0000.14	22003000021	Right support	1	
12	GB/T5783	41002000012	Screw M8X20	2	
13	GB/T93	41300000005	Washer 8	10	
14	065.05.0000.15	22003000022	Left support	1	
15	GB/T810	41212000001	Round nut M60X2	1	
16	GB/T858	41309000007	Washer 60	1	
17	220.01.0650.01	21809000062	Dust ring	1	
18	GB/T301	43010000026	Bearing 51113	1	
19	GB/T276	43001000084	Bearing 6013-2RS	1	
20	060.07.0000.08	21207000007	Base	1	
21	GB/T70.1	41100000007	Screw M4X10	2	
22	GB/T1096	42001000022	Flat key 8X7X14	1	
23	GB/T70.1	41100000094	Screw M10X20	4	
24	GB/T894.1	41305000007	Washer A type 15	6	
25	Q/NRY031		Bearing SF-1-15.15	4	
26	012.03.0000.13	21305000007	Universal wheel carriage	2	
27	GB/T276	43001000010	Bearing 6902-2RS	4	
28	020.03.0042.02	21312000032	Wheel	2	
29	001.02.0150.03	21701000019	Shaft	2	

Handle Assembly

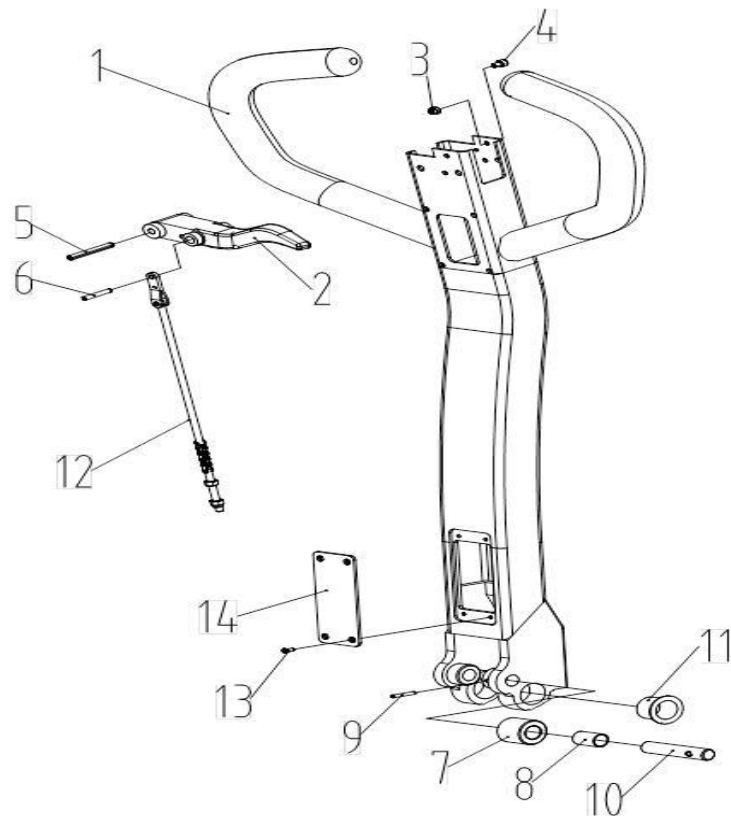

Handle Assembly

Item No	Drawing NO.	Part NO.	Name		Q'ty	Remarks
1	056.02.0107.06	30909000003	Handle bar		1	
2	234.02.0000.04	21405000004	Knob		1	
3	GB/T889.1	41208000002	Locknut M4		1	
4	GB/T70.1	41100000005	Screw M4X8		1	
5	GB/T879	41402000038	Pin 6X40		1	
6	GB/T879	41402000010	Pin 4X25		1	
7	020.01.0026.02	21312000006	Pinch roller		1	
8	Q/NRY031	43100000009	Bearing SF-1-12.20		1	
9	GB/T879	41402000009	Pin 4X20		1	
10	001.01.0120.50	21702000013	Pin		1	
11	Q/NRY031	43101000016	Bearing SF-1F-200.165		2	
12	310.02.0000.13	30915000002	Pull rod assembly		1	
13	GB/T818	41108000011	Screw M4X8		4	
14	263.05.0000.46	20517000012	Plastic cover		1	Gray

Driving Wheel Assembly

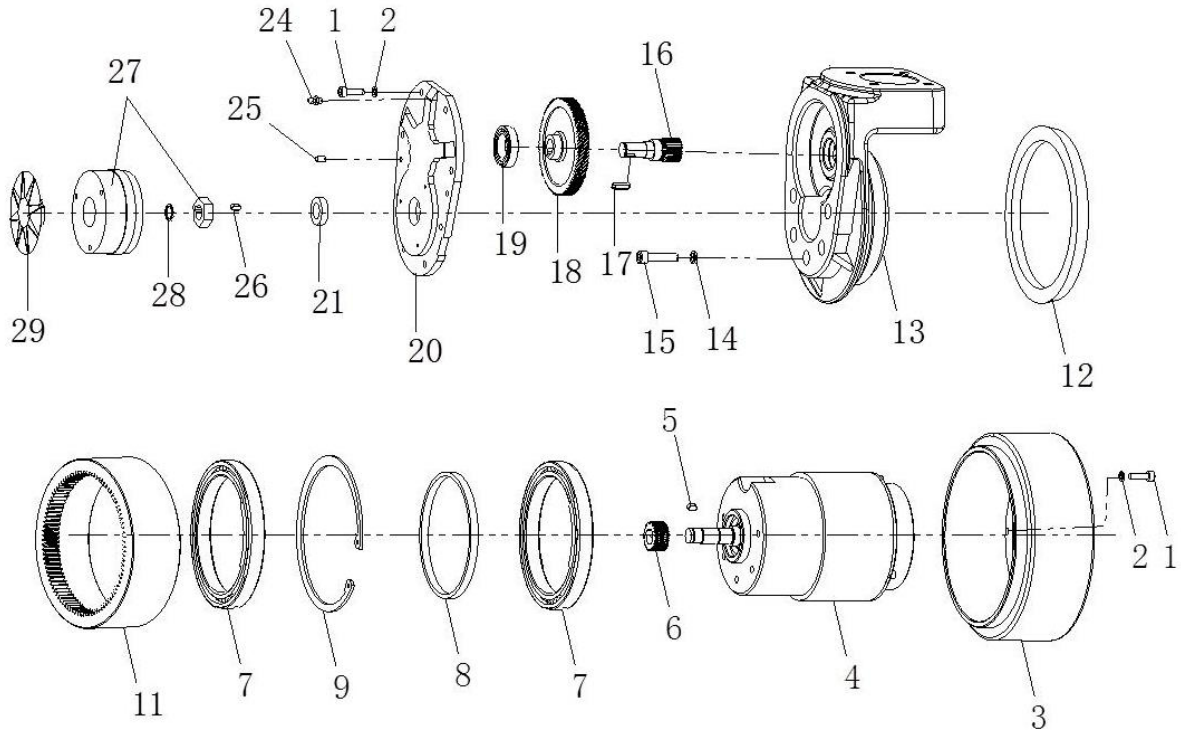

Driving Wheel Assembly

Item No	Drawing NO.	Part NO.	Part name	Q'ty	Remarks
1	GB/T 70.1	41100000043	Screw M6X20	16	
2	GB/T93	41300000004	Washer 6	16	
3	1115-220000-0B	90010000139	Driving wheel	1	
4	Z130BLD650-48A1-30S-00101	90030000071	Brushless motor	1	
5	GB/T1096	42001000006	Flat key 5X5X14	1	
6	1115-200005-0B	90010000140	Helical tooth	1	
7	GB/T276-94	43001000119	Bearing61824-2RS	2	
8	ZD-NL-571-001	90010000141	Adjustment washer	1	
9	GB/T893.1	41304000038	Retainning ring150	1	
11	1115-200002-0B-X	90010000142	Straight tooth ring	1	
12	GB/T13871-92	90010000143	Seal ringΦ155XΦ172X10	1	
13	ZD-RY-504-001	90010000144	Gear box	1	
14	GB/T93	41300000005	Washer 8	5	
15	GB/T 70.1	41100000071	Screw M8X35	5	
16	1115-200003-0B	90010000145	Straight tooth	1	
17	GB/T1096	42001000009	Flat key 5X5X20	1	
18	1115-200004-0B	90010000146	Large tooth	1	
19	GB/T276	43001000035	Bearing61905-ZZ	1	
20	ZD-RY-505-001	90010000147	Gear box cover	1	
21	GB/T13871	44005000036	Seal ring TC16X28X7	1	
24	GB/T7940.1	44001000003	Grease cupM8X1	1	
25	GB/T119.1	41400000006	Pin 5X16	1	
26	GB/T1096	42001000059	Flat key 5X5X8	1	
27	ZD-HZDC-362-001	90010000148	Brake	1	
28	GB/T894.1	41305000007	Retainning ring15	1	
29	ZD-ZJNL-076-001	90010000149	Brake stopple	1	

Connecting Rod and Wheel Carriage Assembly

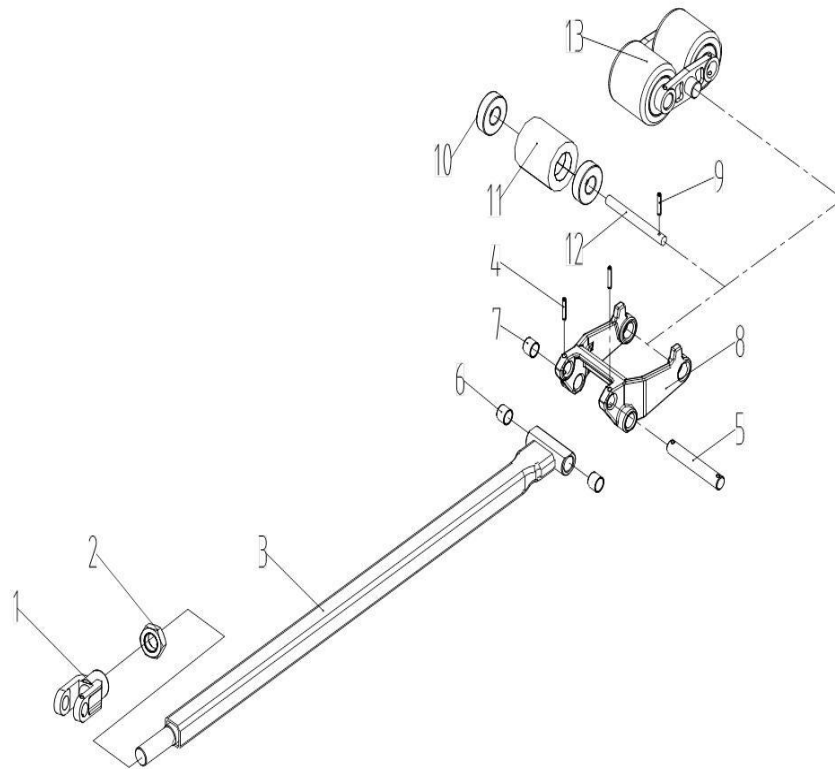

Connecting Rod and Wheel Carriage Assembly

Item No	Drawing NO.	Part NO.	Name		Q'ty	Remarks
1	143.10.0000.10	21106000021	Joint		1	
2	GB/T6173	41203000008	Nut M22X1.5		1	
3	140.01.0101.11	31603000071	Connecting rod assembly	1150	1	
		31603000072	Connecting rod assembly	1220		
4	GB/T879	41402000019	Pin 5X28		1	
5	001.01.0160.09	21702000022	Pin		1	
6	Q/NRY031	43100000019	Bearing SF-1-16.20		1	
7	Q/NRY031	43100000035	Bearing SF-1-20.25		1	
8	012.07.0000.25	21306000036	Wheel carriage		1	
9	GB/T879	41402000022	Pin 5X32	With single wheel	2	
10	GB/T276	43001000025	Bearing 6204-2RS	With single wheel	2	
11	020.21.0080.05	21312000162	Wheel	With single wheel	1	
12	001.01.0200.27	21702000059	Pin	With single wheel	1	
13	010.01.2080.01	31302000026	Double wheel assembly	With double fork wheel(Red PU wheel)	1	

Double Wheel Assembly

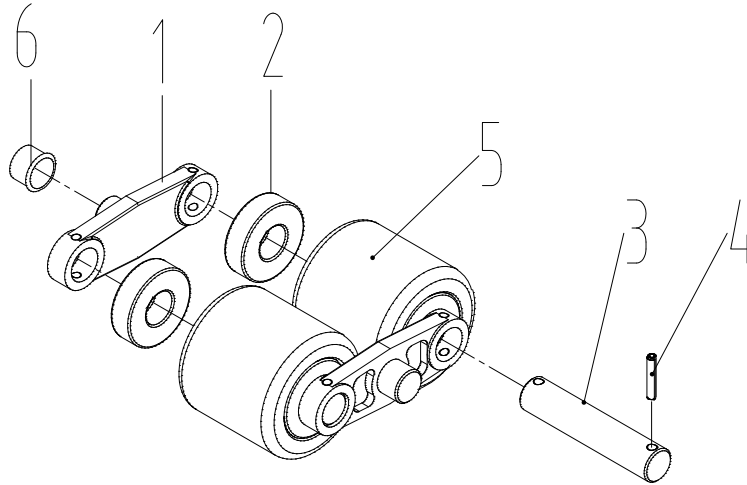

Item No	Drawing NO.	Part NO.	Name	Q'ty	Remarks
1	012.01.0000.02	21221000009	Support plate	2	
2	GB/T276	43001000028	Bearing 6204-Z	4	
3	001.01.0200.15	21702000049	Pin	2	
4	GB/T879	41402000022	Pin 5X32	4	
5	020.21.0080.02	21312000152	Wheel	2	Red
6	Q/NRY031	43101000006	Bearing	2	

**KVALITET GIR
VERDI**

SCANLIFT[®]

The logo graphic consists of two horizontal lines. The top line is red and the bottom line is blue. Both lines are slightly curved, with the ends pointing outwards, creating a stylized, dynamic shape.

E-mail : teknisk@scanlift.no / www.scanlift.no